

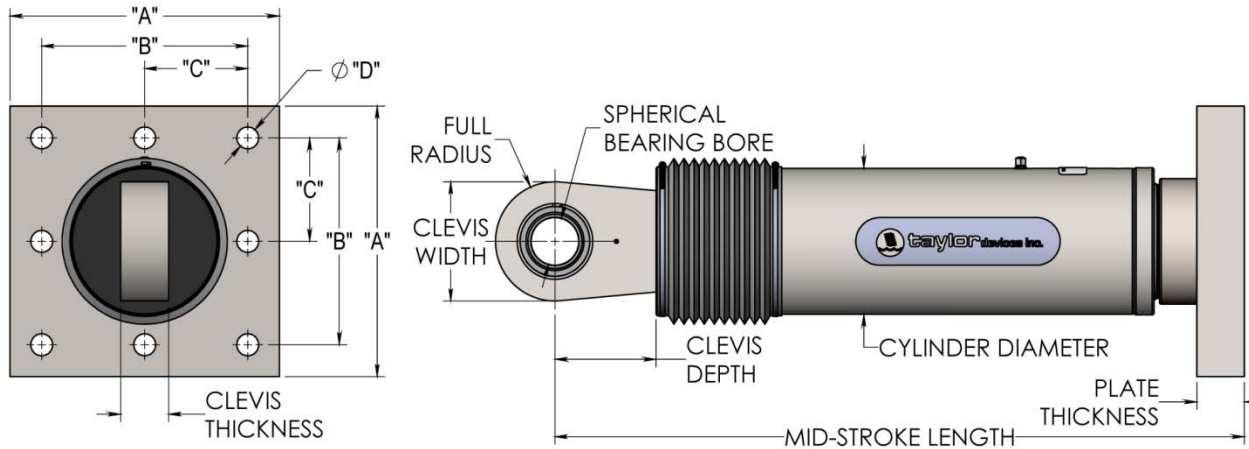

taylor devices inc.

FLUID VISCOUS DAMPERS & LOCK-UP DEVICES



NOTE:

VARIOUS STROKES ARE AVAILABLE, FROM ± 50 TO ± 900 mm. FORCE CAPACITY MAY BE REDUCED FOR STROKE LONGER THAN STROKE LISTED IN THE TABLE. ANY STROKE CHANGE FROM THE STANDARD STROKE VERSION DEPICTED CHANGES THE MIDSTROKE LENGTH BY 5 mm PER ± 1 mm OF STROKE.

EX.: 1000 kN ± 100 mm STROKE, MID-STROKE LG. IS 1048mm
 1000 kN ± 150 mm STROKE, 150-100= 50, 50*5=250
 1048+250 = 1298 mm MID-STROKE LENGTH

BELLOWS MAY BE REPLACED WITH A STEEL SLEEVE AS DESIRED STROKE LENGTHS INCREASE. CONSULT TAYLOR DEVICES FOR STROKE OVER ± 300 mm AND/OR FOR FORCE CAPACITIES FOR STROKE LONGER THAN LISTED IN TABLE.

FORCE (kN)	TAYLOR DEVICES MODEL NUMBER	SPHERICAL BEARING BORE DIAMETER (mm)	MID-STROKE LENGTH (mm)	STROKE (mm)	CLEVIS THICKNESS (mm)	MAXIMUM CLEVIS WIDTH (mm)	CLEVIS DEPTH (mm)	BEARING THICKNESS (mm)	MAXIMUM CYLINDER DIAMETER (mm)	WEIGHT (kg)	"A" (mm)	"B" (mm)	"C" (mm)	"D" (mm)	PLATE THICKNESS (mm)
250	17120	38.10	787	± 75	43	100	83	33	114	44	178 ± 3	127 ± 25	†	20.6 ± 25	38 ± 76
500	17130	50.80	997	± 100	55	127	102	44	150	98	282 ± 3	203 ± 25	†	31.8 ± 25	38 ± 76
750	17140	57.15	1016	± 100	59	155	129	50	184	168	343 ± 3	254 ± 25	127 ± 25	28.7 ± 25	61 ± 76
1000	17150	69.85	1048	± 100	71	185	150	61	210	254	419 ± 3	318 ± 25	159 ± 25	31.8 ± 25	76 ± 1.5
1500	17160	76.20	1105	± 100	77	205	162	67	241	306	432 ± 3	330 ± 25	165 ± 25	34.9 ± 25	76 ± 1.5
2000	17170	88.90	1346	± 125	91	230	191	78	286	500	457 ± 3	343 ± 25	171.5 ± 25	38.1 ± 25	102 ± 1.5
3000	17180	101.60	1441	± 125	117	290	203	89	350	800	508 ± 3	406 ± 25	203 ± 25	41.4 ± 25	102 ± 1.5
4000	17190	127.00	1645	± 125	142	325	273	111	425	1088	**	**	**	**	**
6500	17200	152.40	1752	± 125	154	350	305	121	515	1930	**	**	**	**	**
8000	17210	177.80	1867	± 125	178	415	317	135	565	2625	**	**	**	**	**

† DENOTES 4 HOLE PATTERN, MEANING NO CENTER HOLES.

** CONSULT FACTORY FOR DIMENSIONS.