

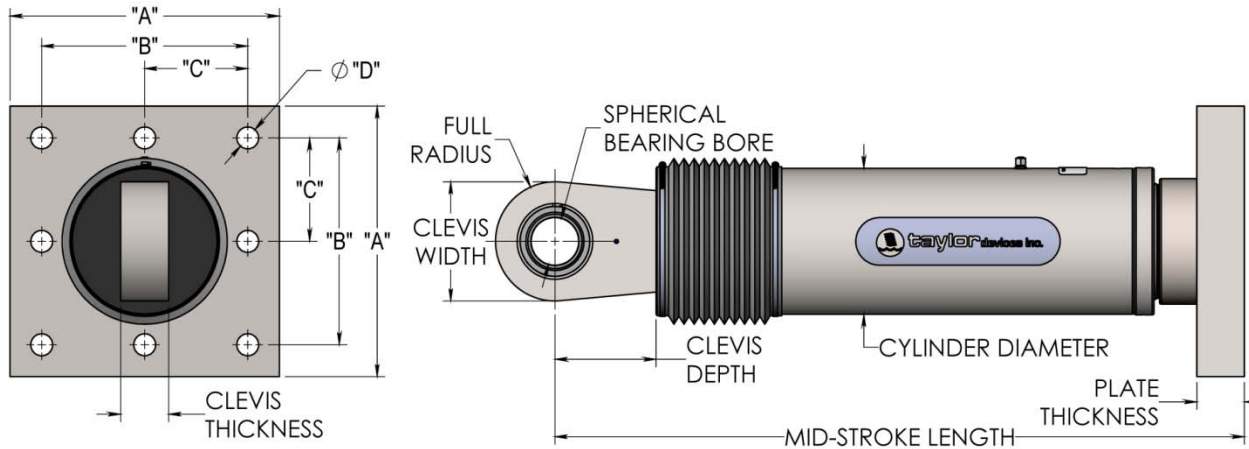

# taylor devices inc.

## FLUID VISCOUS DAMPERS & LOCK-UP DEVICES



NOTE:

VARIOUS STROKES ARE AVAILABLE, FROM  $\pm 2$  TO  $\pm 36$  INCHES. FORCE CAPACITY MAY BE REDUCED FOR STROKE LONGER THAN STROKE LISTED IN THE TABLE. ANY STROKE CHANGE FROM THE STANDARD STROKE VERSION DEPICTED CHANGES THE MIDSTROKE LENGTH BY FIVE INCHES PER  $\pm 1$  INCH OF STROKE.

EXAMPLE: 220 KIP  $\pm 4$ " STROKE, MID-STROKE LG. IS 48.75"  
 220 KIP  $\pm 6$  INCHES STROKE,  $6-4=2$ ,  $2*5=10$   
 $41.25+10 = 51.25$  INCHES MID-STROKE LENGTH

BELLOWS MAY BE REPLACED WITH A STEEL SLEEVE AS DESIRED STROKE LENGTHS INCREASE. CONSULT TAYLOR DEVICES FOR STROKE OVER  $\pm 12$  INCHES AND/OR FOR FORCE CAPACITIES FOR STROKE LONGER THAN LISTED IN TABLE.

FORCE (KIP)	TAYLOR DEVICES MODEL NUMBER	BEARING BORE DIAMETER (IN)	MID-STROKE LENGTH (IN)	STROKE (IN)	CLEVIS THICKNESS (IN)	MAXIMUM CLEVIS WIDTH (IN)	CLEVIS DEPTH (IN)	BEARING THICKNESS (IN)	MAXIMUM CYLINDER DIAMETER (IN)	WEIGHT (LB)	"A" (IN)	"B" (IN)	"C" (IN)	"D" (IN)	PLATE THICKNESS (IN)
55	17120	1.50	31.00	$\pm 3$	1.67	4	3.25	1.31	4½	100	7.00 $\pm$ .12	5.00 $\pm$ .01	†	0.81 $\pm$ .01	1.50 $\pm$ .03
110	17130	2.00	39.25	$\pm 4$	2.16	5	4.00	1.75	5¾	215	11.12 $\pm$ .12	8.00 $\pm$ .01	†	1.25 $\pm$ .01	1.50 $\pm$ .03
165	17140	2.25	40.00	$\pm 4$	2.31	6	5.10	1.97	7¼	370	13.50 $\pm$ .12	10.00 $\pm$ .01	5.00 $\pm$ .01	1.12 $\pm$ .01	2.40 $\pm$ .03
220	17150	2.75	41.25	$\pm 4$	2.78	7¼	5.88	2.40	8¾	560	16.50 $\pm$ .12	12.50 $\pm$ .01	6.25 $\pm$ .01	1.25 $\pm$ .01	3.00 $\pm$ .06
330	17160	3.00	43.50	$\pm 4$	3.03	8	6.38	2.62	9½	675	17.00 $\pm$ .12	13.00 $\pm$ .01	6.50 $\pm$ .01	1.375 $\pm$ .01	3.00 $\pm$ .06
440	17170	3.50	53.00	$\pm 5$	3.56	9	7.50	3.06	11¼	1100	18.00 $\pm$ .12	13.50 $\pm$ .01	6.75 $\pm$ .01	1.50 $\pm$ .01	4.00 $\pm$ .06
675	17180	4.00	56.75	$\pm 5$	4.60	11¼	8.00	3.50	13¾	1750	20.00 $\pm$ .12	16.00 $\pm$ .01	8.00 $\pm$ .01	1.63 $\pm$ .01	4.00 $\pm$ .06
900	17190	5.00	64.75	$\pm 5$	5.56	12¾	10.75	4.38	16¾	2400	**	**	**	**	**
1450	17200	6.00	69.00	$\pm 5$	6.06	13¾	12.00	4.75	20¼	4250	**	**	**	**	**
1800	17210	7.00	73.50	$\pm 5$	7.00	16¼	12.50	5.25	22¼	5775	**	**	**	**	**

† DENOTES 4 HOLE PATTERN, MEANING NO CENTER HOLES.

\*\* CONSULT FACTORY FOR DIMENSIONS.

MADE IN USA